



**HYBRID VAPORIZER**

# USER MANUAL

[www.mygeeko.com](http://www.mygeeko.com)

## INSTRUCTIONS:

### Table of contents:



1. Introducing the Wiz Hybrid Vaporizer
2. Description of the Wiz Hybrid Vaporizer
3. Set-up before use
4. Operating instructions
5. Important information
6. Caution
7. Failure treatment

### 1. INTRODUCING THE WIZ:

- ① Mouthpiece
- ② Aeration chamber
- ③ E-liquid window
- ④ Temperature indicator
- ⑤ Main switch
- ⑥ + Switch
- ⑦ - Switch
- ⑧ ON/OFF switch
- ⑨ USB Port - Type C

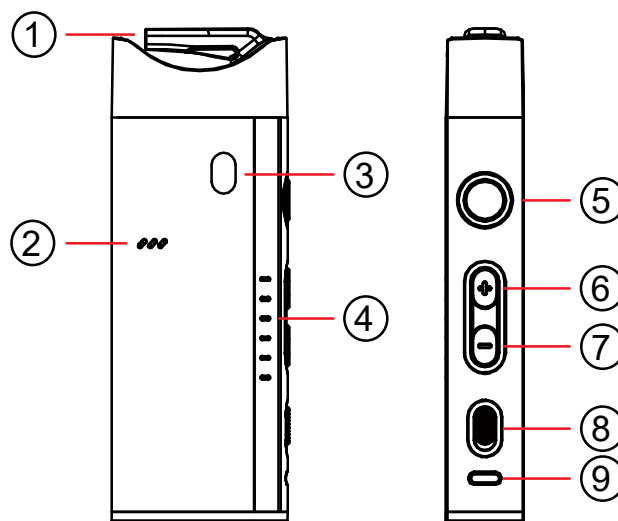

### 2. DESCRIPTION OF THE WIZ:

Topic	Detail
Dimension	145.7*52*23max
Material	Aluminium + PC compound
Voltage	3.5V
USB Type-C	2A
Tank capacity	2ml
Wattage	5-35W
Coil value	0.1Ω-1.0Ω

### 3.SET-UP BEFORE USE:

#### 3.1 Fill the atomizer

Remove the atomizer from the Wiz, unscrew the top of the atomizer, fill the tank with . See image nr 2.

After filling the tank, screw the top back on. See image nr 1. Wait 10 minutes before use in order to let the coil soak in the e-liquid.

Don't use the central tube to fill the tank. See image nr 2.

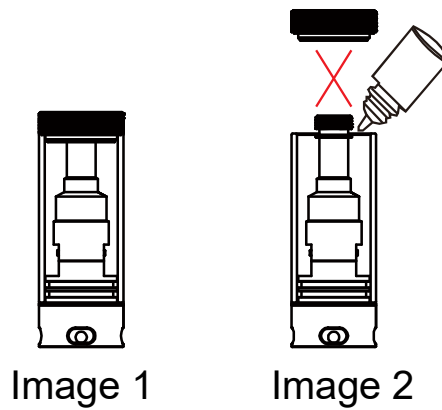

### 3.2 Replace the coil:

3.2.1. Pull on the top of the atomizer in order to remove it from the device.( Image 3.2.1)

3.2.2. Unscrew the bottom of the atomizer.( Image 3.2.2)

3.2.3. Unscrew the the coil from the bottom of the atomizer and replace it with a new coil.( Image 3.2.3)

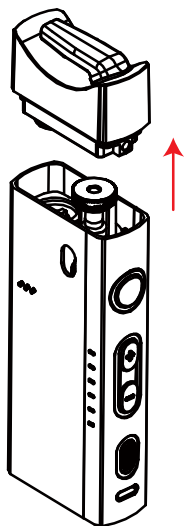

Image 3.2.1



Image 3.2.2



Image 3.2.3

### 3.3 Filling the vaping chamber:

If you wish to vape dry herbs, you can put the herbs directly into the vaping chamber. Tearing the dry herbs into pieces before filling the tank will ensure an optimal vaping.

Crumble the dry herbs before putting them in the vaping chamber in order to get an optimal vaping. If you wish to vape resin, you'll need to use the metal cartridge in order to avoid damaging the chamber.

3.3.1. Removing the top of the Wiz in order to remove the metal cartridge. (Image 3.3.1)

3.3.2. Unscrew the top of the metal cartridge in order to add the resin ; then screw the top back on. Crumble the resing before putting it in the vaping chamber in order to get an optimal vaporisation. (Image 3.3.2)

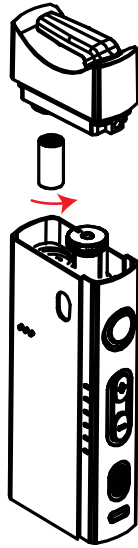

Image 3.3.1

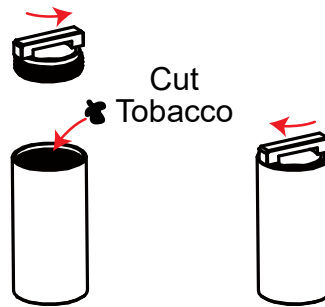

Image 3.3.2

### 3.4 Putting the batteries in:

- 3.4.1. Lift the ring of the battery shut-off valve, then push back the ring in order to lift the valve. (Image 3.4.1)
- 3.4.2. Insert the batteries with the + and – poles in the right direction (as mentioned on the inside of the valve), then close the shut-off valve. (Image 3.4.2)

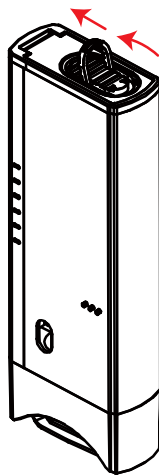

Image 3.4.1

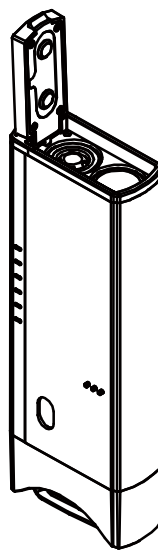

Image 3.4.2

### 3.5 Mouthpiece:

3.5.1. Turn the mouthpiece 180° before use.

(Image 3.5.1)

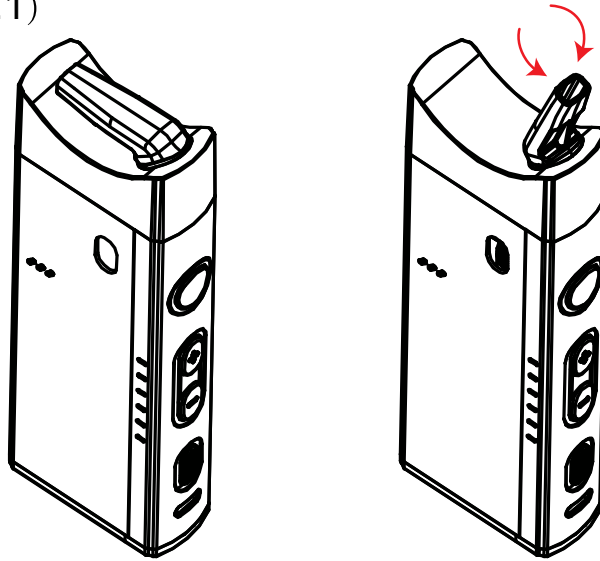

Image 3.5.1

## 4. OPERATING INSTRUCTIONS:

### 4.1 Switch ON/OFF the Wiz

Switch the ON/OFF button to ON. The battery indicator, as well as the other lights, will flicker 3 times and the device will vibrate for 1 second. Switch the ON/OFF button to OFF. The battery indicator, as well as the other lights, will flicker 3 times and the device will vibrate for 1 second.

### 4.2 Function details:

When you switch on your Wiz Hybrid Vaporizer, it automatically starts in combination mode in order to vape a mix of dry herbs and e-liquid. By pushing the main button 3 times, the Wiz Hybrid Vaporizer will switch from one user mode to another. The Wiz Hybrid Vaporizer has 3 user modes : combination mode for mixing e-liquid and dry herbs, dry herbs only and e-liquid only.

These are the signs that show which user mode is switched on :

4.2.1 Dry herbs vaping : All 5 levels of the temperature indicator light up at the same time, in green and during 2 seconds.

4.2.2 E-liquid vaping : The battery indicator lights up in green during 2 seconds.

4.2.3 Combination mode of both types of vaping: The battery indicator and the 5 levels of the temperature indicator all light up at the same time, in green and during 2 seconds.

4.3 Set the temperature when vaping dry herbs:

4.3.1. Use the “+” and “-” buttons in order to select the temperature at which you wish to vape your dry herbs. There are 5 pre-set temperature levels : 180 °C , 190 °C , 200 °C , 210 °C , 230 °C ;

4.3.2. Push the “-” button until you get to temperature OFF. Once « Temperature OFF » is selected, the Wiz Hybrid Vaporizer will no longer heat and the OFF indicator will remain red.

4.4 Temperature indicator:

As long as the Wiz Hybrid Vaporizer hasn't reached the required temperature, the temperature indicator will remain red. Once the device reaches the selected temperature, the light will turn green and your device will vibrate for 2 seconds.

4.5 Charging:

During the charging of the batteries, the battery indicator will display the charging level of the batteries. When the battery indicator is red, it means that the level is below 30% ; an orange light means that the charge is between 30% and 70% ; a green light means that the charge is higher than 70%. When the light turns off, your batteries are charged to 100%.

4.6 Battery indicator:

Red light : charging level < 30%

Orange light : charging level 30%-70%

Green light : charging level > 70%

4.7 How to vape in the different vaping modes:

During e-liquid vaping, keep the main button pressed when vaping.  
During dry herbs vaping, select the required temperature and start vaping ; without pressing the main button.

In mixed mode (combining both modes of vaping), select the temperature and keep the main button pressed when vaping.

## 5.IMPORTANT INFORMATION :

### 5.1 Low battery ( <6.0V)

The battery indicator flickers 20 times.

### 5.2 Atomizer not connected

The battery indicator lights up in red and flickers 5 times.

### 5.3 Atomizer in short-circuit

The battery indicator lights up in red and flickers 3 times.

### 5.4 Vaping for more than 10 seconds

The battery indicator turns red and flickers 10 times.

### 5.5 Atomizer connected

The battery indicator flickers once.

### 5.6 Temperature too high

Battery indicator turns red and flickers 15 times.

### 5.7 Failure to set the temperature

Temperature indicator lights up and flickers 3 times.

## 6.CAUTION!







Do not attempt to disassemble the device. Neither our company nor you vendor will be held accountable for damages or injuries caused by inadequate use or negligence.

## 7.FAILURE TREATMENT :

Status	Possible Cause	Solution
Device does not work in spite of being operated in accordance with the manual	Battery damage or circuit board damage	Please contact your dealer or your supplier to fix the problem
Atomizer is connected but doesn't work	The connection between the atomizer and the device doesn't occur properly.	Check if the atomizer's contact pin connects with the battery's electrode.
Device flickers and shuts off automatically and quickly after being switched on	Battery low	Charge the device

## SAFETY PRECAUTIONS:

Before using your device, please read the following important information to eliminate or reduce any possibility of causing damage and personal injury.

	Do not use in blasting area	Do not use device where blasting is in progress. Follow any regulations and rules strictly.
	Do not use in petrol stations	Do not use device at petrol stations. Don't use near fuel or chemicals. Do not dispose your battery or mobile in fire.
	Do not use in high temperature	Use only in normal position. Do not expose your Box to extremely high temperatures above +60°C (+140°F) . Do not use anything static to clean your Box.
	Qualified service	Only qualified personnel may install or repair this product.
	Batteries, charges, and other accessories	Please use the rechargeable lithium battery which complies with CE safety certification. Third-party chargers that comply with the IEC/EN 62684 standard, and that can connect to your device micro USB connector, may be compatible. Do not connect incompatible products.
	Keep your device dry	Your device is not water-resistant. Keep it dry.
	Glass parts	The device screen is made of glass. This glass can break if the device is dropped on a hard surface or receives a substantial impact. If the glass breaks, do not touch the glass parts of the device or attempt to remove the broken glass from the device. Stop using the device until the glass is replaced by qualified service personnel.

Warning: Please do not disassemble and assemble the device personally if you are not professional technicians. We shall not be responsible for the consequences.